

公差表/General tolerances(mm)		公差表/General tolerances(mm)	
0	>3	>6	>10
~	~	~	~
3	6	10	18
±0.12		±0.18	
±0.26		±0.31	
±0.37		±0.57	
±0.80		±0.93	
±1.05		±1.15	
±1.60		±2.20	
±2.50		±2.50	
±Z		±Z	
0.1/10		0.1/10	

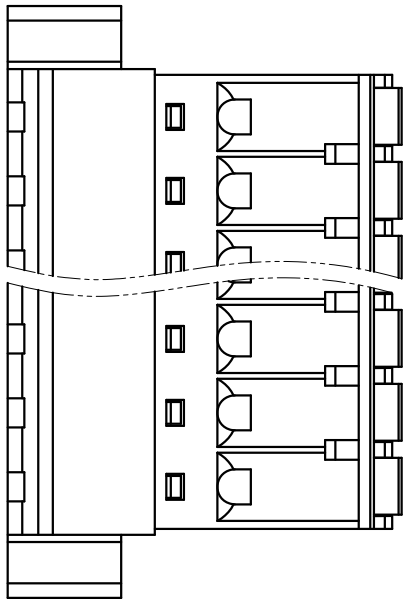
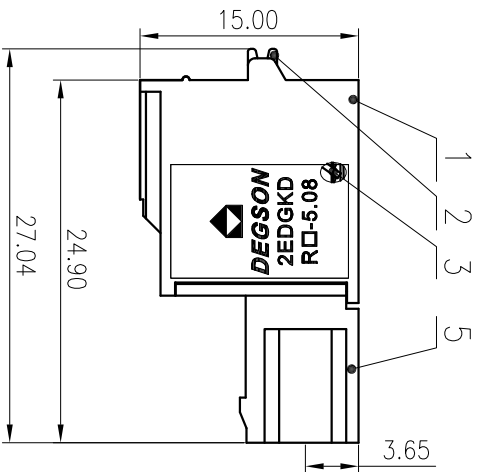
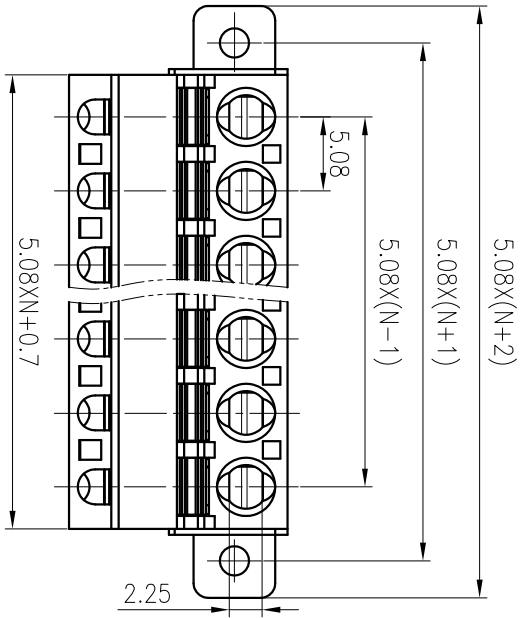
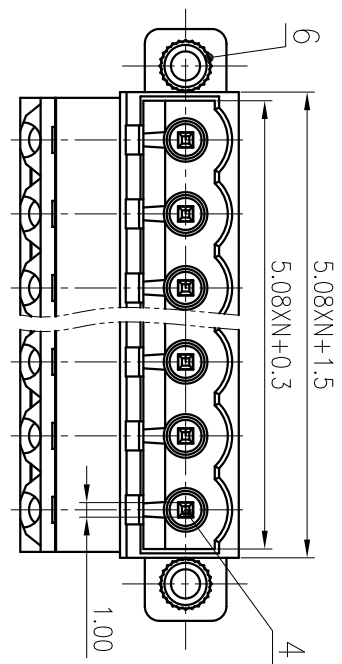

ITEM	NAME OF PART	MATERIAL	NOTES
6	Screw Cap	Copper alloy	
5	Cover	PA66	UL94V-0
4	Clamp	Copper	Sn plated
3	Spring	Stainless steel	
2	Button	PA66	UL94V-0
1	Housing	PA66	UL94V-0

UL 标准/UL Standard:	B	C	D
额定电压/电压/Rated Voltage(V)/Current(A)	300/10	/	/
IEC 标准/IEC Standard:	/	/	/
过压类别/Overvoltage Category/污染等	III/3	III/2	II/2
级/Pollution Degree	/	/	/
额定电压/电流/Rated Voltage(V)/Current(A)	250/12	/	/
工频耐压/Withstanding Voltage(V/Min)	AC2500	/	/
导线范围 (硬线和软线) /Wire Range(rigid and flexible)(mm <sup>2</sup> /AWG)	0.2~2.5/26~12	/	/
间距/Pitch(mm)/线数范围/Poles	5.08/N=02~22P	/	/
剥线长度/Stripping length(mm)	9~10	/	/
使用温度范围/Operating temperature(°C)	-40~+105	/	/
符合RoHS环保要求/Conform to RoHS	Yes	/	/

SURFACE: /

MATERIAL:	/
MAT NO.:	/
STATUS:	/
APP: L/G	2020.06.03
CHKD: Mek	2020.06.03
DRAFT: LuoXM	2020.06.03
NAME:	2EDGKDRP-5.08-XXP-1Y-00A (H)
DRAWING NO.:	2EDGKDRP-5.08-C01
TYPE:	CUSTOMER DRAWING

REV	ECN	DESCRIPTION	DRAFT	DATE	SIZE	SCALE	REV	SHEET
1					A4	2:1	T1	1/1

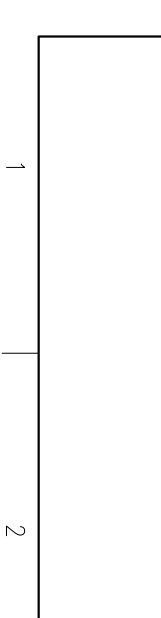

1 2 3 4 5 6